

# STAPLES & PFEIFFER

PRODUCT OF

THE HELLAN® STRAINER COMPANY

## MODEL 135B BRONZE 150 LB. FLANGED SIMPLEX STRAINER WITH BOLTED COVER

### MATERIALS (COVER & BODY)

Bronze: ASTM B61,  
ASTM C-958

### FLANGES

ANSI  
DIN  
Navy (MIL-F-20042D)

### APPROVALS

ABS  
US Navy  
Lloyd's Register

### SCREEN MATERIALS

316 SS, Monel

### CONNECTION SIZES

1/2" – 16" (15mm – 406mm)

### SCREENS

20 – 100 mesh  
1/32" – 1/4" perforated

### MILITARY STANDARDS

MIL-S-16293  
MIL-S-2593



Simplex strainers are used to remove damaging debris from liquid flow that can be interrupted. Baskets are designed for an open area ratio of at least 6:1, which means less operating costs to clean the baskets. The heavy-duty wall thickness offers lower life cycle costs. Strainers have been shock tested to MIL-S-901D.

# MODEL 135B – SIMPLEX STRAINER

## MODEL 135B BRONZE 150 LB. FLANGED SIMPLEX STRAINER WITH BOLTED COVER

SIZES 1/2" – 16"  
DIMENSIONS AND WEIGHTS

SIZE	in	1/2	3/4	1	
	mm	15	20	25	
A	in	7-5/8	7-5/8	7-5/8	
	mm	194	194	194	
B	in	4	4	4	
	mm	102	102	102	
C	in	3	3	3	
	mm	76	76	76	
D	in	1/4	1/4	1/4	
	mm	6	6	6	
E	SCREEN	in	11	11	11
	REMOVAL	mm	279	279	279
<b>WEIGHTS</b>					
	lbs	8	9	10	
	kgs	3.6	4.1	4.5	

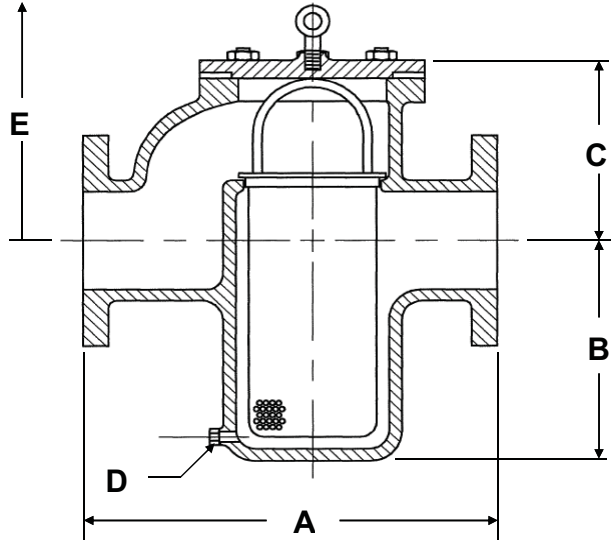

SIZE	in	1-1/4	1-1/2	2	2-1/2	3	4	5	6	8	10	12	14	16	
	mm	32	40	50	65	75	100	125	150	200	250	300	350	400	
A	in	7-5/8	9	9-3/8	10-1/2	12-1/2	12-1/4	16-1/2	16	24-1/4	30	38-1/4	40	40	
	mm	194	229	238	267	318	311	419	406	616	762	972	1016	1016	
B	in	4	6	6	12-1/2	8	16	17	15	15	19	20	22	25-1/2	
	mm	102	152	152	318	203	406	432	381	381	483	508	559	648	
C	in	3	4	5	6	6	6	6-1/4	10-1/2	10	14-1/2	16-3/4	19-1/2	22	
	mm	76	102	127	152	152	152	159	267	254	368	425	495	559	
D	in	1/4	3/4	3/8	3/4	3/4	3/4	3/4	3/4	3/4	3/4	1-1/2	1-1/2	3/4	
	mm	6	19	10	19	19	19	19	19	19	19	38	38	19	
E	SCREEN	in	11	12-1/8	12-1/2	19	18	24	27-1/4	30-3/4	32	42-1/2	50-3/4	56-1/2	57-1/2
	REMOVAL	mm	279	308	318	483	457	610	692	781	813	1080	1289	1435	1461
<b>WEIGHTS</b>															
	lbs	11	45	45	60	65	128	200	160	385	850	1468	1600	2483	
	kgs	5	20	20	27	29	58	91	72	175	386	666	726	1126	

Approximate Dimensions and Weights. Apply for Certified Drawings.

*Manufactured with quality in the USA*

CLEVELAND, OHIO USA  
PHONE (216) 206-4200 • FAX (216) 206-4242  
WWW.HELLANSTRAINER.COM

**THE HELLAN® STRAINER COMPANY**